

FINAL ASSEMBLY - BATTERY TO POWER PAC PRO

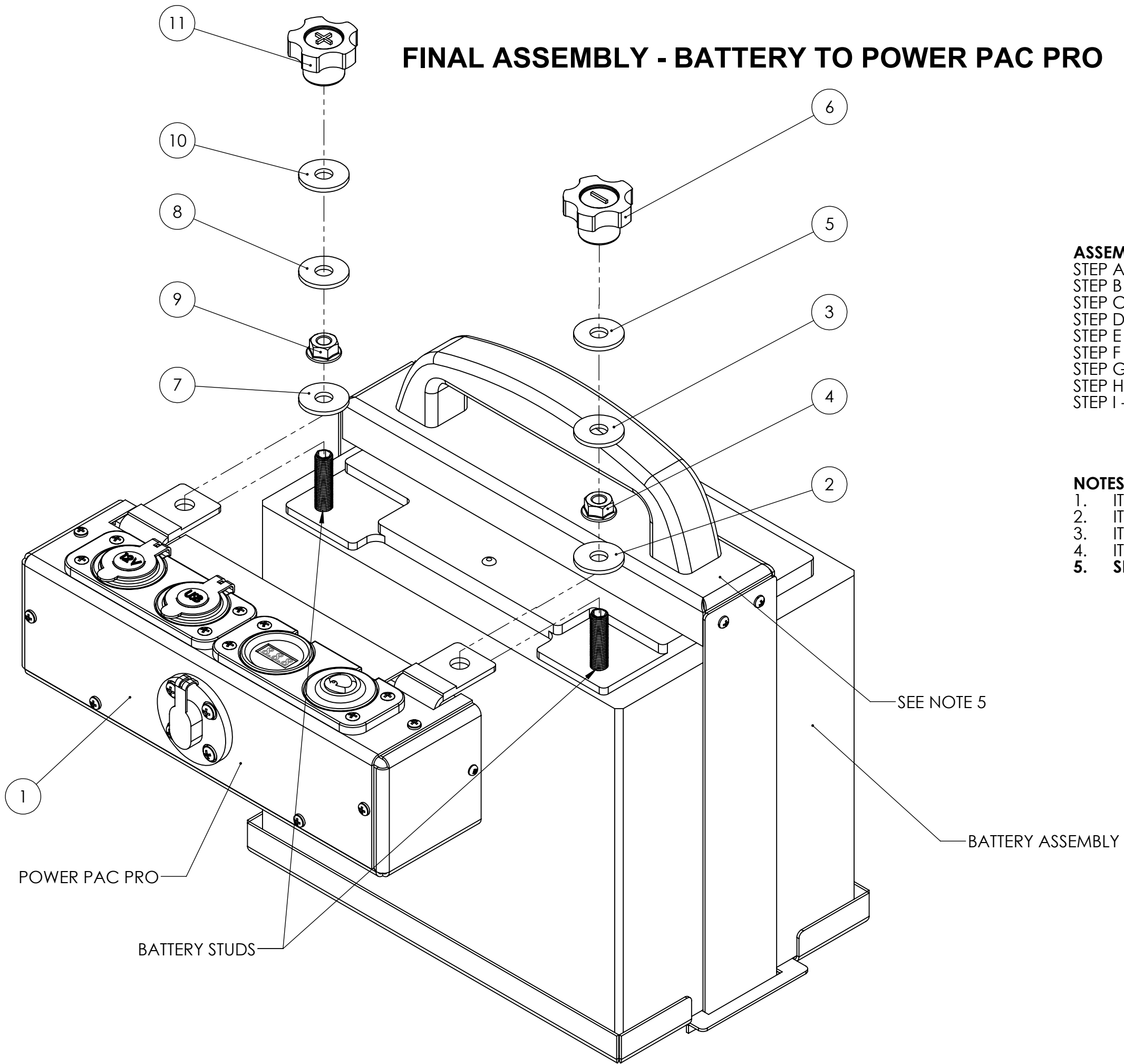

ASSEMBLY INSTRUCTIONS

- STEP A - PLACE ITEM 1 ONTO BATTERY STUDS.
- STEP B - PLACE ITEM 2 ONTO NEGATIVE STUD.
- STEP C - ADD ITEM 4 TO NEGATIVE STUD AND TIGHTEN.
- STEP D - PLACE ITEM 3 AND 5 ON NEGATIVE STUD.
- STEP E - ADD ITEM 6 TO NEGATIVE STUD AND HAND TIGHTEN.
- STEP F - PLACE ITEM 7 ONTO POSITIVE STUD.
- STEP G - ADD ITEM 9 ON POSITIVE STUD AND TIGHTEN.
- STEP H - PLACE ITEMS 5 AND 10 ON POSITIVE STUD.
- STEP I - ADD ITEM 11 TO POSITIVE STUD AND HAND TIGHTEN.

NOTES:

- 1. ITEMS 2,3,5,7,8 AND 10 ARE M8 FLAT WASHERS.
- 2. ITEMS 4 AND 9 ARE M8 FLANGED NUTS.
- 3. ITEM 6 IS NEGATIVE KNOB.
- 4. ITEM 11 IS POSITIVE KNOB.
- 5. **SHOWN WITH VIPER ASSIST LIFT HANDLE KIT.**